



Extremely lightweight harness for skitouring, mountaineering and glacier tours.

DESCRIPTION

Construction made of HMPE (high-modulus polyethylene) lace webbing which is super lightweight and strong.

Tying in two color distinguished tying loops with a strength of 15 kN.

Two gear loops with a load capacity of 5 kg. Each gear loop is divided into 3 sections which allow easier gear management. Gear loop is made of thin webbing and long enough that doesn't restraint when wearing a backpack.



Fine nylon fabric inside the harness doesn't absorb water and it is very breathable.

Two slots for the additional plastic carabiner Porter to carry ice screws or other gear.

Opening and adjusting the leg loops with the patented 12 mm wide Rock&Lock aluminium buckle. Easy and fast manipulation even with gloves on.

Two elastic loops on each leg loop for comfortable carrying an ice screw.

KEY FEATURES

- can be put on/off safely and quickly with skis/crampons on with feet on the ground
- super packable size

STANDARDS

CE 1019
EN 12277

FEATURES



96 g / 3.39 oz (M)



3 YEARS warranty

MATERIALS



- 42 % HMPE
- 37 % PAD
- 12 % light aluminium alloy
- 4 % PES
- 3 % POM
- 2 % rubber

TECHNICAL DATA

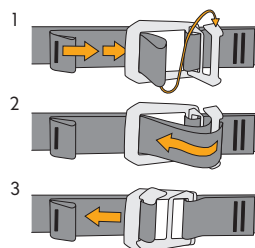

	S	M	L	XL
A [cm/in]	71-83 / 28-32.6	78-90 / 30.7-35.4	85-97 / 33.4-38.2	92-104 / 36.2-40.9
B [cm/in]	48-55 / 19-21.6	53-60 / 20.8-23.6	58-65 / 22.8-25.6	63-70 / 24.8-27.5

